

0.50 mm. FCC/FPC SIDE ENTRY ZIF SMT CON.



0525 SERIES. 0.50mm (0.020") Pitch.

General Features

- Available in 4 through 50 circuits
- Zero insertion force (ZIF) and high retention force
- Accept 0.30 mm thickness FPC. Downside contact
- Easy for FPC installation and reliable operation
- With metal fixed SMT tabs to secure connector on PCB
- Low profile 0.96 mm.

Materials

- Body: High temperature plastic UL 94 V-0
- Slider: High temperature plastic UL 94 V-0
- Contact: Phosphor bronze
- Fixed tab: Brass
- Operating temperature. -40°C to + 85°C
- RoHS compliant

Electrical Features

- Voltage rating: < 50 V
- Current rating: < 0.50 A
- Contact resistance: < 20 mΩ
- Dielectric Withstanding Voltage: 250 V AC/minute
- Insulation Resistance: >100 MΩ
-

Mechanical Features

- FFC/ FPC retention force: > 0.20 Kg/contact
- Durability: 20 cycles

Materials

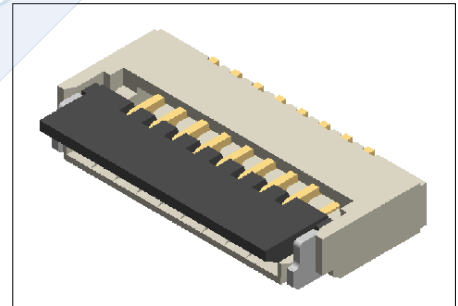
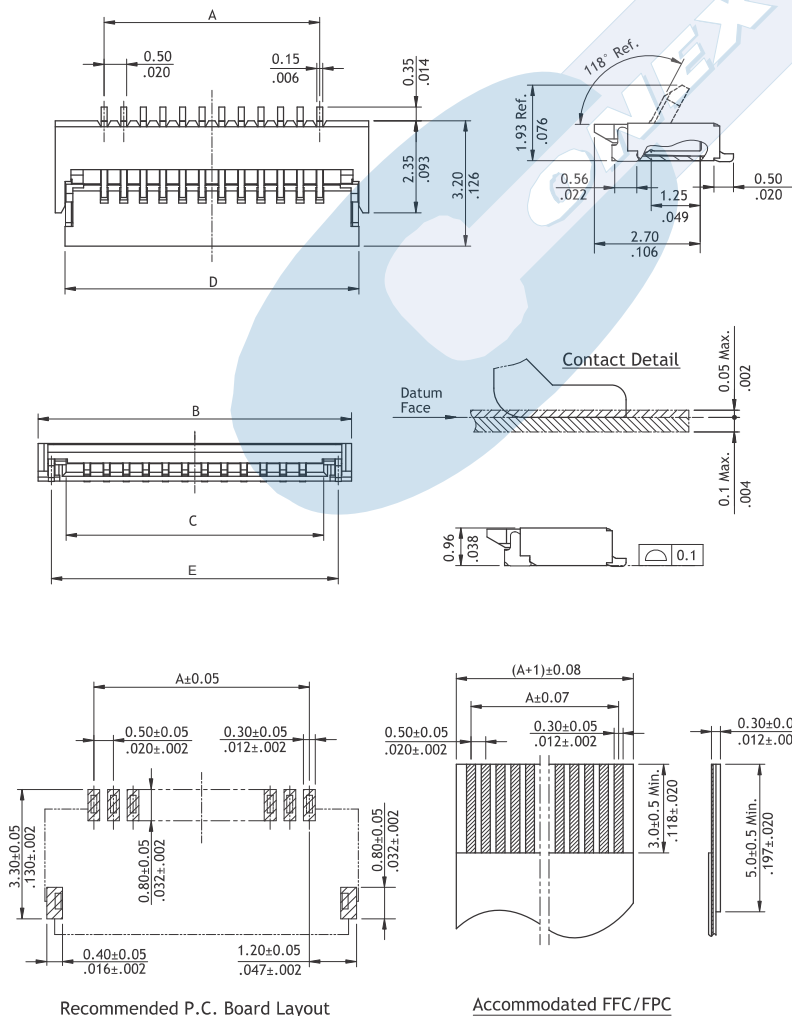

Ordering Information:

0525 - 2- XX- E
 1 2 3 4

1. Connector Series

2. (T) Contact Plating

- T = 2. Tin plated

3. (XX) Number of circuits

- Available in 4 through 50 circuits

4. (E) Packing Options

- E = 1. Tube
- E = 2. Reel + Pad

DIMENSIONS:

- A = 0.5 x (xx*-1)
- B = 0.5 x (xx*) + 2.00
- C = 0.5 x (xx*) + 0.57
- D = 0.5 x (xx*) + 1.50
- E = 0.5 x (xx*) + 1.32

*(XX) = Circuits (4 through 50)